

## EXTERNAL LIGHT SWITCHES - MAINTENANCE PRACTICES

### 1. General

- A. External light switches maintenance practices consist of light switch removal/installation.

### 2. External Light Switches Removal/Installation

- A. Remove External Light Switches (Refer to Figure 201).

**NOTE:** For airplanes 20800500 and On and Airplanes 208B2000 and On, there is a LED panel installed on the left switch panel.

- (1) Remove the nut (7) that attaches the switch (3) to the instrument panel, and
- (2) Push switch through the instrument panel.
- (3) Retain the washers (2) and (6) for the switch installation.
- (4) Identify and disconnect electrical leads.
- (5) Remove the switch from the airplane.

- B. Install External Light Switches (Refer to Figure 201).

- (1) Identify and connect the electrical leads to the switch.
- (2) Install the washers (2) and (6) on the switch body and secure using nut (10).
- (3) Install the switch (3) through instrument panel.
- (4) Attach the switch to the instrument panel with the nut (7).

Figure 201 : Sheet 1 : External Light Switches Installation

A22360

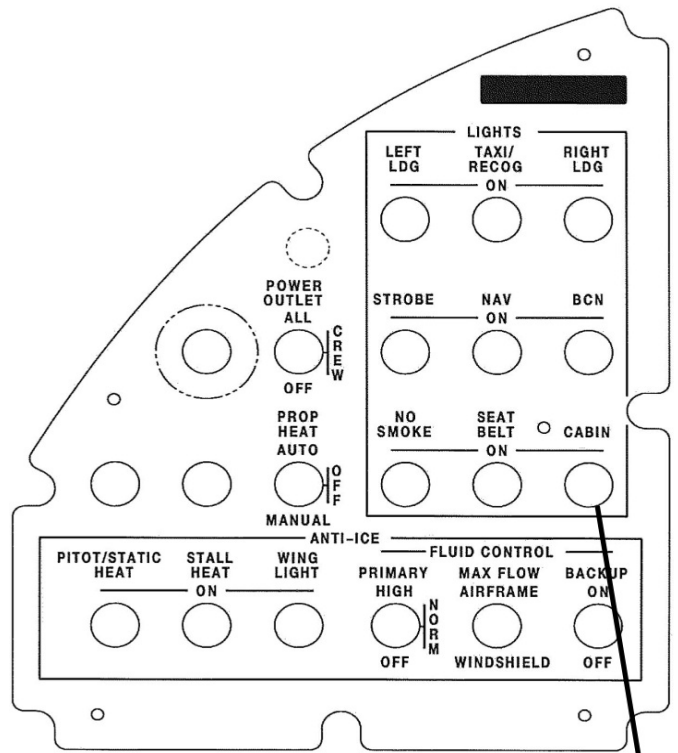
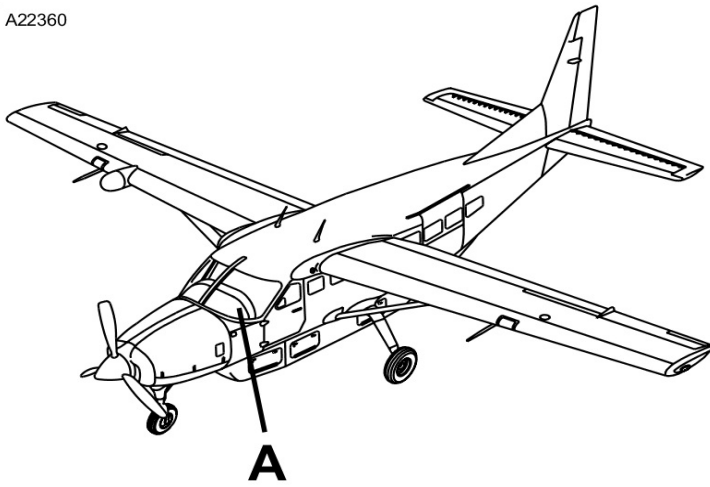

**DETAIL A**

LEFT SWITCH PANEL (TYPICAL)  
 AIRPLANES 20800500 AND ON AND  
 AIRPLANES 208B2000 AND ON

1. SCREW
2. WASHER
3. SWITCH
4. NUT
5. WASHER
6. WASHER
7. NUT

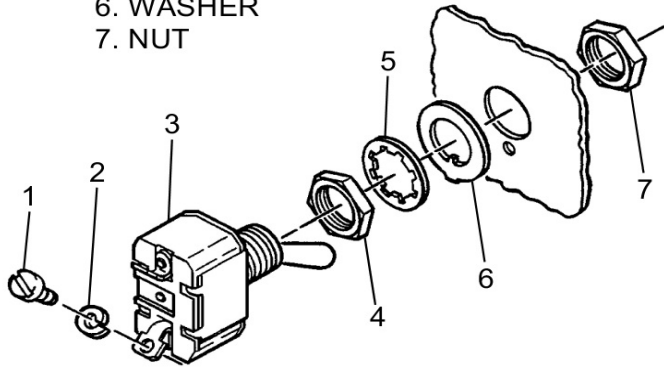

**DETAIL B**

TYPICAL PASSENGER COMPARTMENT  
 LIGHT SWITCH INSTALLATION

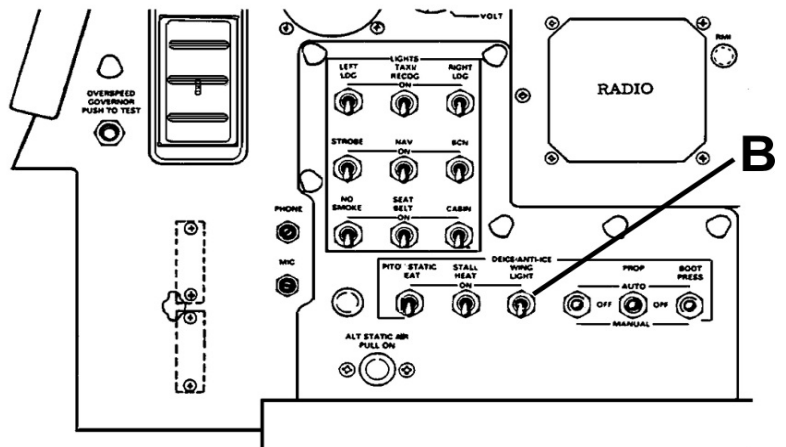

**DETAIL A**

LOWER INSTRUMENT SWITCH PANEL (TYPICAL)  
 AIRPLANES 20800001 THRU 20800499 AND  
 AIRPLANES 208B0001 THRU 208B1999

2610T7004  
 A2619R1180  
 A2618R1187  
 B2618R1188